

**EXAMPLE FOR PLOT PLAN  
RESIDENTIAL MINIMUM REQUIRED  
YARD SETBACKS**

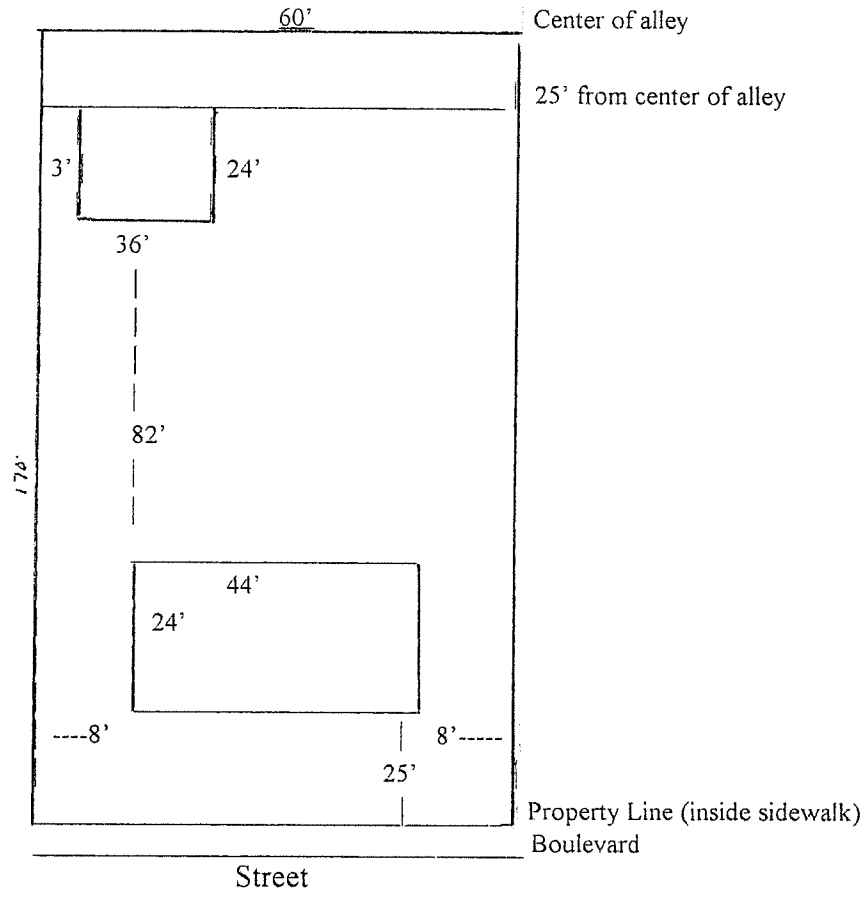

**SETBACKS**

- "A" Rear Yard - R1 = 25 feet required from center of alley.
- "B" Side Yard - R1 = 3 feet for accessory buildings; 8 feet for principal dwellings.
- "C" Front Yard - R1 = 25 feet minimum from inside sidewalk.
- "D" Fence Setback - R1 = 2 feet.

**OTHER DEVELOPMENT RESTRICTIONS**

- 1) Accessory buildings shall not occupy more than 30% of the required area for the rear yard.
- 2) Maximum dwelling height: 30 feet.
- 3) Maximum accessory building size: 1000 sq. ft.; 10 ft. sidewalls; 20 ft. at peak.
- 4) No fence shall exceed 4 feet in height in the front yard or 8 feet in the rear yard.
- 5) Every fence shall be constructed so that the side containing the framing supports and cross pieces face the interior of the fence owner's lot.